



**Montara Water
and Sanitary District**
Serving the Community of Montara and Moss Beach

P.O. Box 370131
8888 Cabrillo Hwy
Montara, CA 94037-0131
t: 650.728.3545 • f: 650.728.8556

To sensitively manage the natural resources entrusted to our care, to provide the people of Montara - Moss Beach with reliable, high – quality water, wastewater, and trash disposal at an equitable price, and to ensure the fiscal and environmental vitality of the district for future generations. Be open to providing other services desired by our community.

AGENDA

District Board of Directors

January 20, 2022 at 7:30 p.m.

THIS MEETING WILL BE HELD REMOTELY UNDER PARAGRAPH (1) OF SUBDIVISION (e) OF GOVERNMENT CODE SECTION 54953 DUE TO THE CURRENT PROCLAIMED STATE OF EMERGENCY. THIS MEETING WILL NOT HAVE A PHYSICAL LOCATION.

Directors, staff and the public may participate remotely via the application ZOOM:

ZOOM MEETING INFORMATION:

WEBSITE: <https://us02web.zoom.us/j/87806373464?pwd=cWZBb0I5R2sralo5ZWxtT1AvWGVsUT09>

MEETING ID: 878 0637 3464

Password: 368115

CALL IN PHONE NUMBER: +1 669 900 9128

Clemens Heldmaier is inviting you to a scheduled Zoom meeting.

INSTRUCTIONS for remote access are available at <https://support.zoom.us/hc/en-us/articles/201362193-Joining-a-Meeting>. You also may view video during the meeting via live stream or after the meeting at <https://videoplayer.telvue.com/player/wuZKb9gwEY7sMACIIsr7VSJgIB35kNZA/stream/159?fullscreen=true&showtabssearch=false&autostart=false> . If you experience technical difficulties or have technical questions prior to or during the meeting, please contact MWSD's IT support at (650) 728-7843.

Note: Public participation is not permitted during closed session discussion items.

Public Comment

In accordance with the Government Code, members of the public may address the Board on specific agenda items when the matter is announced by the Board President. Any other item of interest that is within the subject matter jurisdiction of the District may be addressed during the Oral Comments portion of the meeting. A "raise hand" button is available for every Zoom user wishing to speak and should be used to alert the President of the intent to comment.

Upon request, this Agenda and written agenda materials will be made available in appropriate alternative formats to persons with a disability. Request for a disability-related modification or accommodation in order to participate in the public meeting should be emailed to info@mwsd.net or submitted by phone at 650-728-3545 at least two days before the meeting. Requests will be granted whenever possible and resolved in favor of accessibility.

Subject to Change: Given the current public health emergency and the rapidly evolving federal, state, and local orders, the format of this meeting may be altered, or the meeting may be canceled. You may check on the status of the meeting by visiting the District's website at: <http://mwsd.montara.org> .

CALL TO ORDER

ROLL CALL

PRESIDENT'S STATEMENT

ORAL COMMENTS (Items other than those on the agenda)

PUBLIC HEARING

CONSENT AGENDA (none)

OLD BUSINESS (none)

NEW BUSINESS

1. [Review and Possible Action Concerning Water System Capital Improvements Program Implementation.](#)
2. [Review of MWSD's Receipt of Association of California Water Agencies Joint Powers Authority President's Special Recognition Award.](#)

REPORTS

1. Sewer Authority Mid-Coastside Meetings (Slater-Carter).
2. MidCoast Community Council Meeting (Slater-Carter).

3. CSDA Report (Lohman).
4. LAFCo Report (Lohman).
5. Attorney's Report (Fitzgerald).
6. Directors' Reports.
7. General Manager's Report (Heldmaier).

FUTURE AGENDAS

CONVENE IN CLOSED SESSION

CONFERENCE WITH LEGAL COUNSEL – EXISTING LITIGATION (Government Code §54956.9(d)(1))

Case Name: *City of Half Moon Bay v. Granada Community Services District, et al.* (Santa Clara County Superior Court No. 17CV316927)

CONFERENCE WITH LEGAL COUNSEL- ANTICIPATED LITIGATION Significant Exposure to Litigation pursuant to paragraph (2) of subdivision (d) of Gov. Code § 54956.9 (1 potential case)

CONFERENCE WITH LEGAL COUNSEL- ANTICIPATED LITIGATION

(Government Code §54956.9(d)(4)) Initiation of Litigation (1 potential cases)

CONFERENCE WITH REAL PROPERTY NEGOTIATORS (Government Code §54956.8)

Property: 771 Rivera Rd., Montara, CA

Agency Negotiators: District General Manager; District General Counsel Negotiating parties: Coast Wholesale Florists, a corporation/Miller-Havice Ranch Under Negotiation: Price and Terms of Payment.

PUBLIC EMPLOYEE PERFORMANCE EVALUATION

(Government Code §54957(b)(1))

Title: General Manager

CONFERENCE WITH LABOR NEGOTIATORS

(Government Code §54957.6)

Unrepresented Employee: General Manager

REPORT OF ACTION TAKEN IN CLOSED SESSION, IF ANY

ADJOURNMENT

The District has a curfew of 10:30 p.m. for all meetings. The meeting may be extended for one hour by vote of the Board.



MONTARA WATER AND SANITARY DISTRICT AGENDA

For Meeting Of: **January 20, 2022**

TO: BOARD OF DIRECTORS

FROM: Clemens Heldmaier, General Manager

SUBJECT: Review and Possible Action Concerning Water System Capital Improvements Program (CIP) Implementation

The Pillar Ridge Supply Reliability Project is a multi-faceted improvement project that will ultimately provide the Pillar Ridge neighborhood and the entire District with a more reliable drinking water supply. This project was included in the District's 2021/2022 Water CIP and is currently being implemented.

Project Objective

The Pillar Ridge Supply Reliability Improvement Project aims to enhance the supply reliability, drought resiliency and operational capacity of the Pillar Ridge facilities and MWSD system through key infrastructure improvements.

Project Scope of Work

Through an assessment of Pillar Ridge operations and a condition assessment of the existing facilities, key improvement projects have been identified to increase supply reliability, facilities resilience, and operational efficiency.

The proposed Project includes the following major elements:

- **Groundwater Supply Wells' Rehabilitation:** The three (3) existing potable water wells that currently supply the Pillar Ridge system will be rehabilitated to restore the wells to their original rated capacity or better. Rehabilitation would include: camera inspection, installation of level transducer(s), installation of VFD(s), chemical cleaning, potential re-drilling, possible upgrade of pump(s), shroud(s), drop-pipe and other well head appurtenances.
- **Water Treatment Plant (WTP) Rehabilitation:** The treatment processes inside the existing treatment plant building will be updated to efficiently treat the water from the Pillar Ridge wells and maintain acceptable water quality. The treatment process will include an oxidation – filtration packaged unit to treat iron and manganese. The existing aging aeration tower and settling tank will be removed and replaced with a more efficient step to address volatile organic compounds (VOCs).

- **New infrastructure to hydraulically connect the Pillar Ridge distribution system to the MWSD distribution system:** The installation of a new booster pump station and yard piping at the Pillar Ridge WTP will complete the physical consolidation between MWSD and Pillar Ridge by allowing water from the Pillar Ridge storage tanks to feed the Schoolhouse Zone and the Schoolhouse tanks.
 - **Booster Pump Station:** The new booster pump station will include a set of two (2) 5-horsepower (hp) vertical mounted centrifugal pumps (one active and one standby) that will operate at 50 gallons per minute (gpm) at the total dynamic head (TDH) of approximately 196 feet that is required to reach the Schoolhouse tanks. The pumps will be located on a new concrete pad of approximately 12 feet by 12 feet, on the West side of the existing WTP building. A flow meter will be installed downstream of the pumps, at a proper distance based on manufacturer recommendations.
 - **Yard Piping:** The new booster pump station discharge piping will tie into the existing 4-inch main that currently allows the transfer of water coming from the Schoolhouse Zone (through the 8-inch pipe under the Airport) directly to the WTP and to the Pillar Ridge tanks¹. The existing 4-inch and 8-inch piping, which also allows water to flow directly into the Pillar Ridge distribution system, would therefore experience bi-directional flow, depending on the operating scenario (sending water from the Schoolhouse Zone to Pillar Ridge or vice versa).
 - **WTP Electrical Upgrades:** The electrical panel at the WTP is aging and needs to be replaced to accommodate the rehabilitated and upgraded facilities. The installation of a generator will provide permanent backup power and increase the resilience of the installed facilities, which are regularly subjected to planned fire prevention power outages.
 - **Existing Storage Tanks:** The two (2) existing 70,000-gallon bolted steel water storage tanks located at the WTP site will be demolished and replaced with two (2) 98,000-gallon welded steel tanks that will provide sufficient operational and fire storage for the Pillar Ridge Zone. The new tanks will occupy the same footprint as the existing tanks, with a diameter of 40 feet and a sidewall height of approximately 11 feet. The total height of the tank will depend on the detailed tank design and freeboard requirements. The configuration of the new tanks will ensure that the storage volume is fully available for use and will be compliant with latest seismic requirements. As such, the new tanks will improve the water
-

shortage resilience of the Pillar Ridge zone and increase operational flexibility for MWSD.

- **Replacement of the existing hydro-pneumatic system:** The existing 5,000-gallon horizontal hydro-pneumatic tank is aging and its replacement will ensure proper operation and adequate water pressures throughout the distribution system. The new hydro-pneumatic tank will have a similar configuration and will be located at the WTP site, where the existing hydro-pneumatic tank is currently located. The approximate footprint for the hydro-pneumatic tank is anticipated to remain unchanged.
- **Installation of access points along the supply transmission mains:** The installation of bi-directional street cleanouts at three (3) locations along the transmission mains between the groundwater supply wells and the WTP will provide key new access points to the transmission piping network. The new access points will allow for proper jet-cleaning and maintenance of the pipes, which are experiencing significant iron deposits that impact the pipe's flow capacity.

RECOMMENDATION:

This item is for the Board of Directors information only.



MONTARA WATER AND SANITARY DISTRICT PILLAR RIDGE WATER TREATMENT PLANT IMPROVEMENT PROJECT VOLUME II - DRAWINGS 30% DESIGN

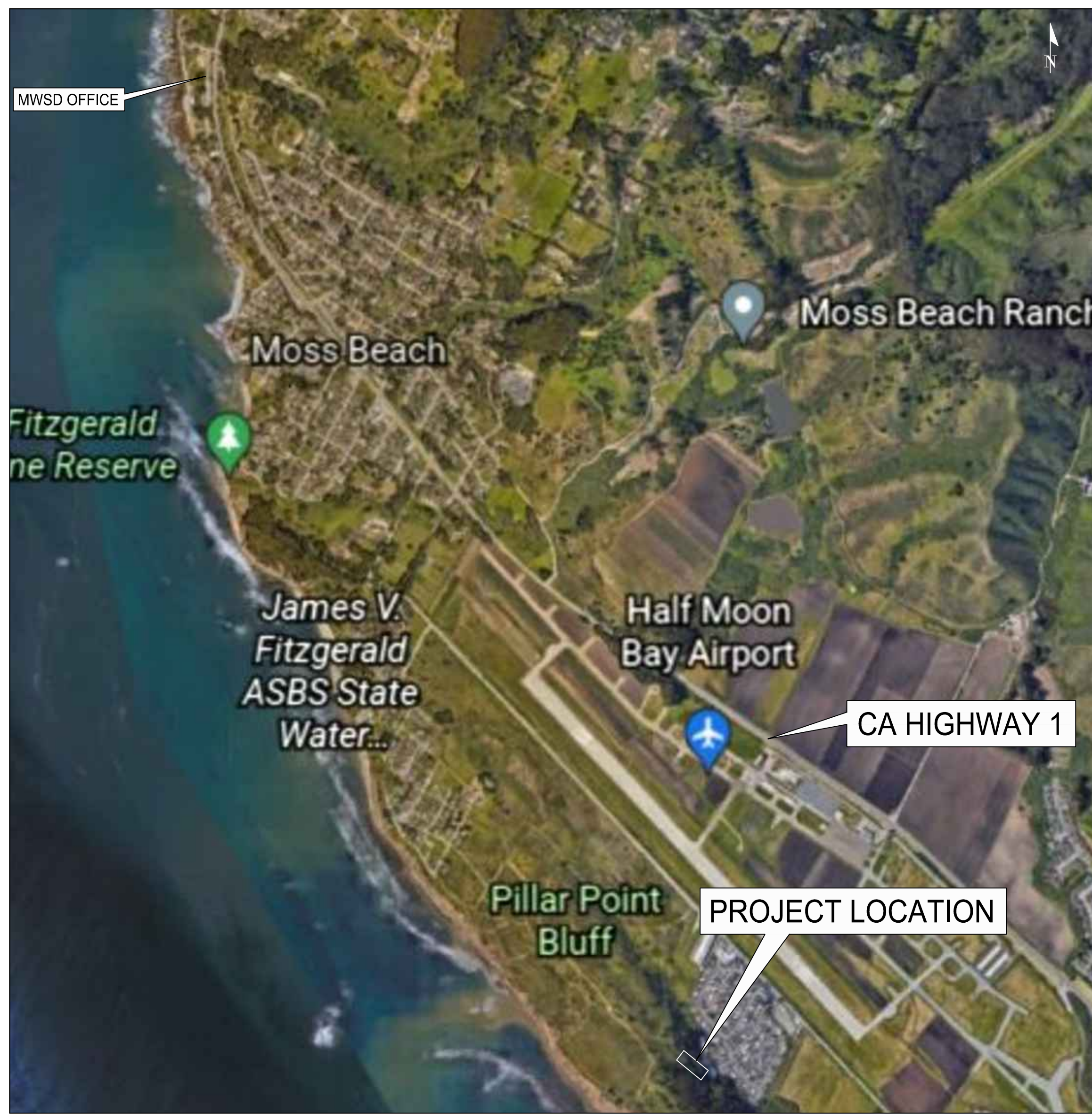

LOCATION MAP
SCALE: NONE

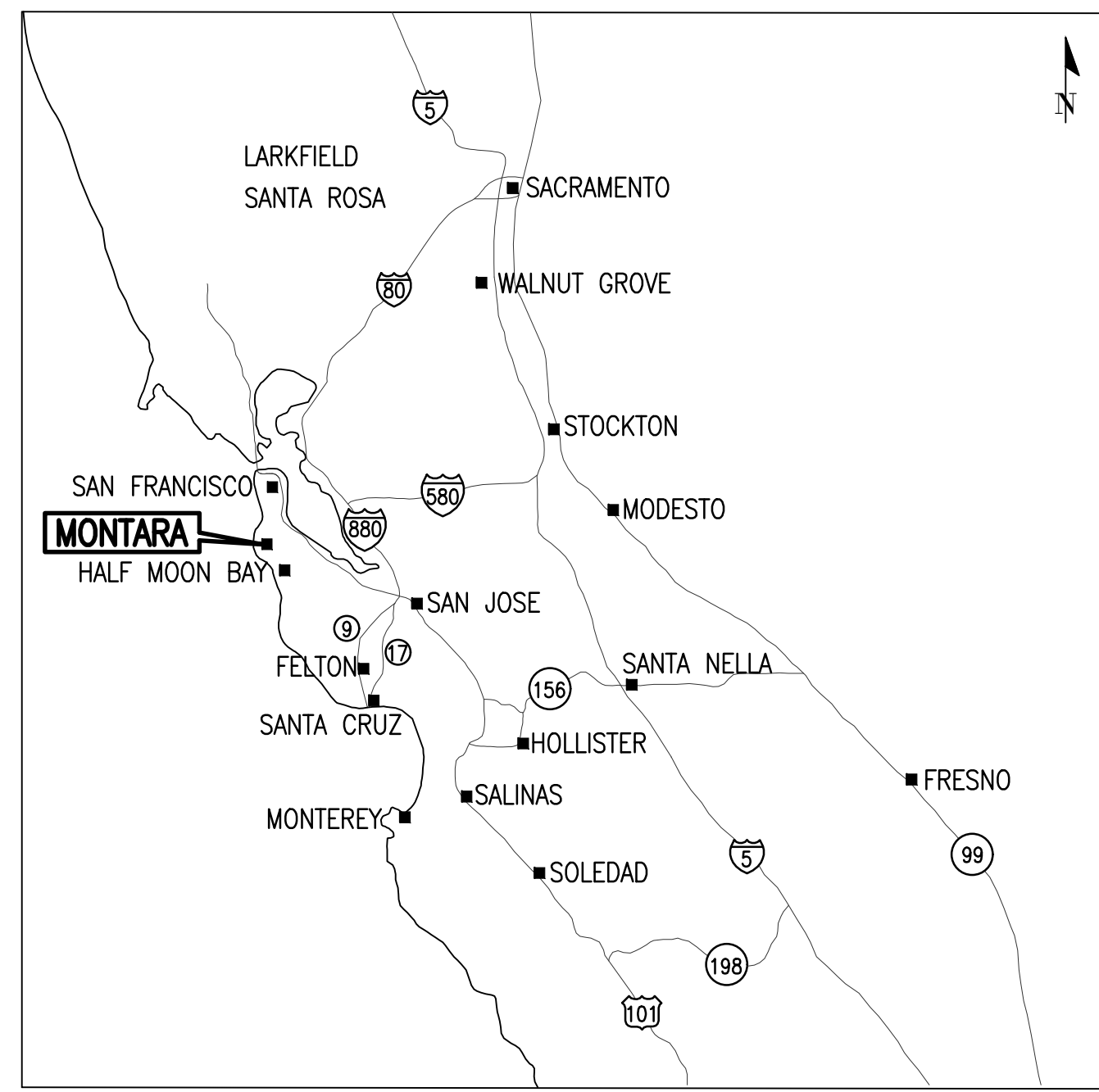

VICINITY MAP
SCALE: NONE

SHEET INDEX

DRAWING NO.	SHEET NO.	TITLE
G01	1	TITLE SHEET
G02	2	NOTES, LEGEND, AND ABBREVIATIONS
D01	3	DEMOLITION PLAN
C01	4	PROCESS FLOW DIAGRAM
C02	5	SITE PLAN
C03	6	PUMP PLAN
C04	7	STORAGE TANK PLAN AND SECTION
C05	8	TANK DETAILS
M01	9	MECHANICAL PLAN
M02	10	MECHANICAL DETAILS

PROJECT DIRECTORY

OWNER: MONTARA WATER AND SANITARY DISTRICT 8888 CABRILLO HIGHWAY MONTARA, CA 94037 PH: (650)728-3545	CIVIL ENGINEER: SRT CONSULTANTS 792 BAY STREET SAN FRANCISCO, CA 94109 PH: (415)776-5800 FAX: (415)776-5200	CONTRACTOR: TBD
---	---	-------------------------------

VERIFY SCALE

BAR IS ONE INCH ON ORIGINAL DRAWING. IF NOT ONE INCH ON THIS SHEET, ADJUST SCALES ACCORDINGLY.

SYMBOL	DESCRIPTION	DATE	APPROVED
-	30% DESIGN	01/2022	

NOT FOR CONSTRUCTION

SRT
consultants
792 Bay Street
San Francisco, CA 94109
Ph 415.776.5800
Fx 415.776.5200

**MONTARA WATER AND
SANITARY DISTRICT**
8888 CABRILLO HIGHWAY
MONTARA CA 94037

PILLAR RIDGE WATER
TREATMENT PLANT
IMPROVEMENT PROJECT

TITLE SHEET







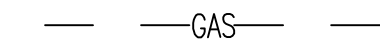
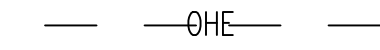
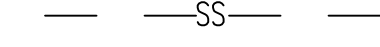
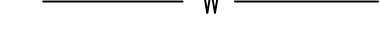

DATE	JAN 2022
SCALE	AS SHOWN
DESIGN	EGBEOLA-MARTIAL
DRAWN	CHIMELSKI
CHECK	MAO
SHEET	01 of 10
G01	

DRAWING NAME: \\Nereve\mnt\01_PROJECTS\Montara Water and Sanitary District (1000)\01_ACTIVE\Pillar Ridge Improvements\02_TASKS\CAD\Sheets\G01.dwg
PLOT DATE: Jan 12, 2022 - 3:36pm
PLOTTED BY: Laura

GENERAL NOTES

- NOTIFY UNDERGROUND SERVICE ALERT (USA) 48 HOURS PRIOR TO ANY EXCAVATION. CALL 811.
- CONTRACTOR'S ATTENTION SHALL BE MADE TO THE TYPICAL TRENCH DETAIL.
- CONTRACTOR'S SUPERINTENDENT IS REQUIRED TO ATTEND A PRE-CONSTRUCTION WALK-THROUGH MEETING. SUPERINTENDENT IS REQUIRED TO BE ON JOB SITE DURING ALL PHASES OF THE WORK AND CONTRACTOR SHALL NOT REPLACE SUPERINTENDENT WITHOUT PRIOR WRITTEN APPROVAL OF MONTARA WATER AND SANITARY DISTRICT (MWSD). A MOBILE PHONE NUMBER AND A 24-HOUR EMERGENCY NUMBER SHALL BE PROVIDED FOR CONTRACTOR'S SUPERINTENDENT.
- CONTRACTOR SHALL BE RESPONSIBLE FOR LOCATING ALL EXISTING FACILITIES AND EXISTING UTILITIES AND POT HOLING AS NECESSARY TO CONFIRM SIZE, DEPTH, ALIGNMENT AND MATERIAL OF EXISTING FACILITIES. THE TYPES, LOCATIONS, SIZES, AND DEPTHS OF EXISTING OR PLANNED UNDERGROUND OR ABOVEGROUND UTILITIES, STRUCTURES, ROADS, PIPELINES, TOPOGRAPHY, ETC., AS SHOWN ON THESE PLANS WERE OBTAINED FROM SOURCES OF VARYING RELIABILITY. A REASONABLE EFFORT HAS BEEN MADE TO LOCATE UTILITIES AND STRUCTURES. HOWEVER, MWSD IS NOT RESPONSIBLE FOR THE COMPLETENESS OR ACCURACY OF SAID INFORMATION.
- CONTRACTOR IS SOLELY RESPONSIBLE FOR COMPLIANCE WITH ALL APPLICABLE SAFETY LAWS OF ALL JURISDICTIONAL AGENCIES. CONTRACTOR IS ALSO RESPONSIBLE FOR PROJECT SITE SAFETY AND FOR PUBLIC SAFETY INCLUDING TRAFFIC CONTROL, 24 HOURS PER DAY FOR ALL DAYS FROM NOTICE TO PROCEED THROUGH THE NOTICE OF FINAL COMPLETION.
- ALL MATERIALS AND INSTALLATION OF WATER SYSTEM APPURTENANCES SHALL BE IN ACCORDANCE WITH THE STANDARDS AND SPECIFICATIONS OF MWSD AND SAN MATEO COUNTY. CONTRACTOR TO PROVIDE A MATERIALS SUBMITTAL TO MWSD FOR APPROVAL PRIOR TO BEGINNING WORK.
- CONTRACTOR IS SOLELY RESPONSIBLE FOR ALL DAMAGE TO EXISTING PROPERTY AND STRUCTURES RESULTING FROM HIS OPERATIONS DURING CONSTRUCTION AND SHALL REPLACE IN KIND OR BETTER TO THE SATISFACTION OF THE PROPERTY OWNER AND/OR MWSD PRIOR TO THE FINAL PAYMENT. THE CONTRACTOR SHALL EXERCISE CARE WHEN WORKING NEAR RETAINING WALLS AND SHALL BE RESPONSIBLE FOR RESTORING ANY WALL TIE-BACKS DISTURBED DURING EXCAVATION. ANYTHING NOT SPECIFICALLY CALLED OUT ON PLANS TO BE PROTECTED IN PLACE SHALL BE ASSUMED TO REQUIRE PROTECTION IN PLACE.
- ALL FACILITIES TO BE OWNED AND MAINTAINED BY MWSD SHALL BE INSPECTED AND APPROVED BY MWSD, INCLUDING INSPECTION AND APPROVAL OF ALL FITTINGS, PIPES, AND CONNECTIONS PRIOR TO BACKFILLING.
- IF A MAIN BREAK OCCURS WITHIN THE SCOPE OF THE PROJECT, CONTRACTOR SHALL NOTIFY MWSD IMMEDIATELY, AND SHALL BE RESPONSIBLE FOR REPAIRING THE BREAK.
- GENERAL CONSTRUCTION SEQUENCE:
 - LOCK OUT TAG OUT
 - DEMOLISH EXISTING SYSTEM AND DISPOSE OFF SITE
 - INSTALL NEW MECHANICAL PIPING AND EQUIPMENT
 - PRESSURE TEST ALL NEW PIPING
 - TEST NEW SYSTEMS
 - VENDOR STARTUP AND MWSD STAFF TRAINING
 - DEMOBLIZE
- STAGING AREA TO BE DETERMINED IN THE FIELD WITH MWSD.
- CONSTRUCTION OPERATION TO BE COORDINATED WITH MWSD, PARTICULARLY WITH RESPECT TO USE OF CRANE(S).

LEGEND

-  — GAS — PG&E NATURAL GAS
-  — OHE — OVERHEAD ELECTRICAL
-  — SS — SANITARY SEWER
-  — W — WATER
-  — T — TELECOMMUNICATION CABLE
-  — - - — PROPERTY LINE
-  VALVE
-  GATE VALVE
-  BUTTERFLY VALVE
-  CHECK VALVE
-  FLOW ARROW

ABBREVIATIONS

(E)	EXISTING
(E/F)	EXISTING AND FINISHED
AC	ASPHALT CONCRETE
AGG	AGGREGATE
APPROX.	APPROXIMATE
ARV	AIR RELEASE VALVE
BO	BLOW OFF
CB	CATCH BASIN
CIP	CAST IRON PIPE
CMP	CORRUGATED METAL PIPE
CONC	CONCRETE
CTE	CONNECT TO EXISTING
DI	DUCTILE IRON
DIA	DIAMETER
EP	EDGE OF PAVEMENT
GRD	GRADE
BRK	BREAK
HORIZ.	HORIZONTAL
HWY	HIGHWAY
INV	INVERT
LF	LINEAR FEET
MOV	MOTOR OPERATED VALVE
MAX	MAXIMUM
MIN	MINIMUM
MWSD	MONTARA WATER AND SANITARY DISTRICT
NC	NORMALLY CLOSED
NIC	NOT IN CONTRACT
PB	PULL BOX
PP	POWER POLE
PVC	POLYVINYL CHLORIDE PIPE
SHT	SHEET
SPECS	SPECIFICATIONS
SS	SANITARY SEWER
SSMH	SANITARY SEWER MANHOLE
SST	STAINLESS STEEL
STA	STATION
SVC	SERVICE
T.O.P.	TOP OF PIPE
TBD	TO BE DETERMINED
TYP	TYPICAL
UG	UNDERGROUND
VCP	VITRIFIED CLAY PIPE
V.I.F.	VERIFY IN FIELD
VERT.	VERTICAL
VFD	VARIABLE FREQUENCY DRIVE
W/	WITH
WTR	WATER

NO.	SYMBOL	DESCRIPTION	DATE	APPROVED
1			01/2022	

NOT FOR CONSTRUCTION

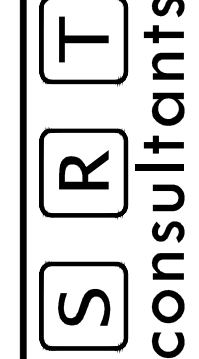
consultants
 792 Bay Street
 San Francisco, CA 94109
 Ph 415.776.5800
 Fx 415.776.5200

**MONTARA WATER AND
 SANITARY DISTRICT**
 8888 CABRILLO HIGHWAY
 MONTARA CA 94037

**PILLAR RIDGE WATER
 TREATMENT PLANT
 IMPROVEMENT PROJECT**
**NOTES, LEGENDS,
 AND ABBREVIATIONS**

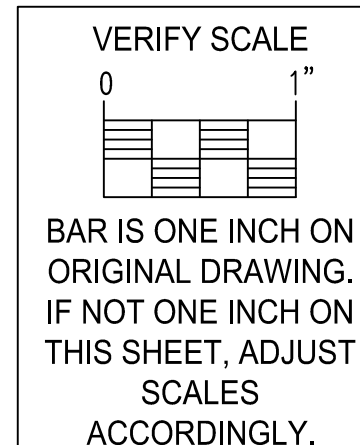

DATE	JAN 2022
SCALE	AS SHOWN
DESIGN	EGBEOLA-MARTIAL
DRAWN	CHIMELSKI
CHECK	MAO
SHEET	02 of 10
G02	

DRAWING NAME: \\newserv\proj\01_PROJECTS\Montara Water and Sanitary District (1000)01_ACTIVE\Pillar Ridge Improvements\02_TASKS\CAO\Sheets\001.dwg
 PLOT DATE: Jan 12, 2022 3:43pm
 PLOTTED BY: Laura

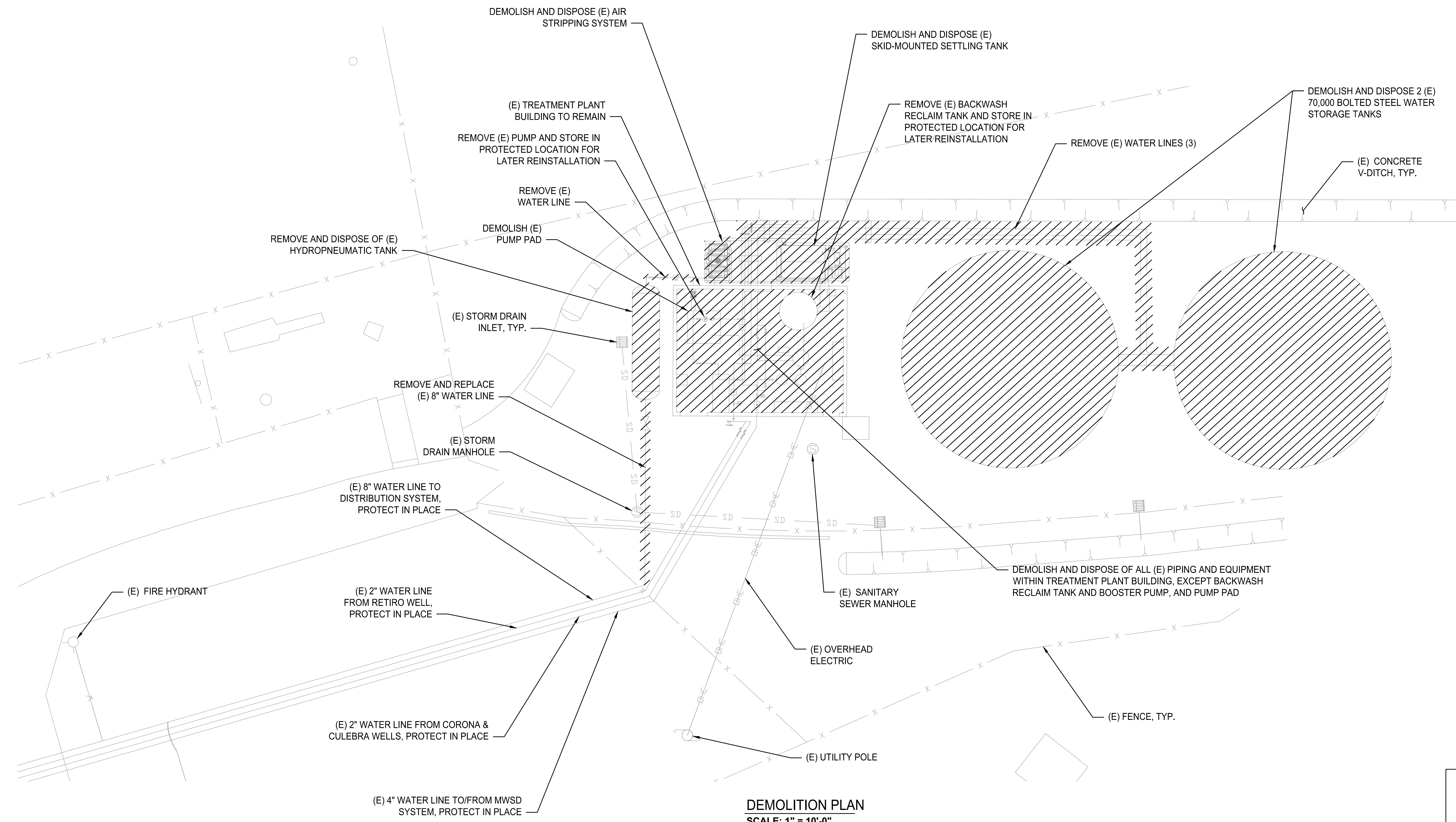
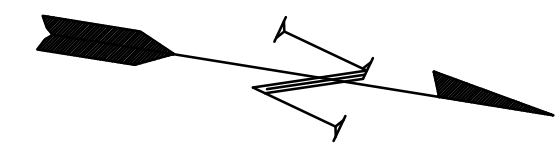

DEMOLITION PLAN
 SCALE: 1" = 10'-0"

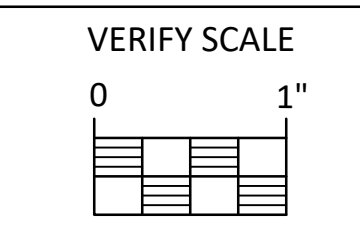

BAR IS ONE INCH ON ORIGINAL DRAWING. IF NOT ONE INCH ON THIS SHEET, ADJUST SCALES ACCORDINGLY.

SYMBOL	DESCRIPTION	DATE	APPROVED
-	30% DESIGN	01/2022	---

NOT FOR CONSTRUCTION

SRT consultants
 792 Bay Street
 San Francisco, CA 94109
 Ph. 415.776.5800
 Fx. 415.776.5200

MONTARA WATER AND SANITARY DISTRICT
 8888 CABRILLO HIGHWAY
 MONTARA, CA 94037

PILLAR RIDGE WATER TREATMENT PLANT IMPROVEMENT PROJECT
 DEMOLITION PLAN

DATE	JAN 2022
SCALE	AS SHOWN
DESIGN	EGBEOLA-MARTIAL
DRAWN	CHIMELSKI
CHECK	MAO
SHEET	03 of 10

D01

NOTE:
 1. BACKWASH RECYCLING FEASIBILITY TO BE CONSIDERED ONCE PLANT IS OPERATIONAL

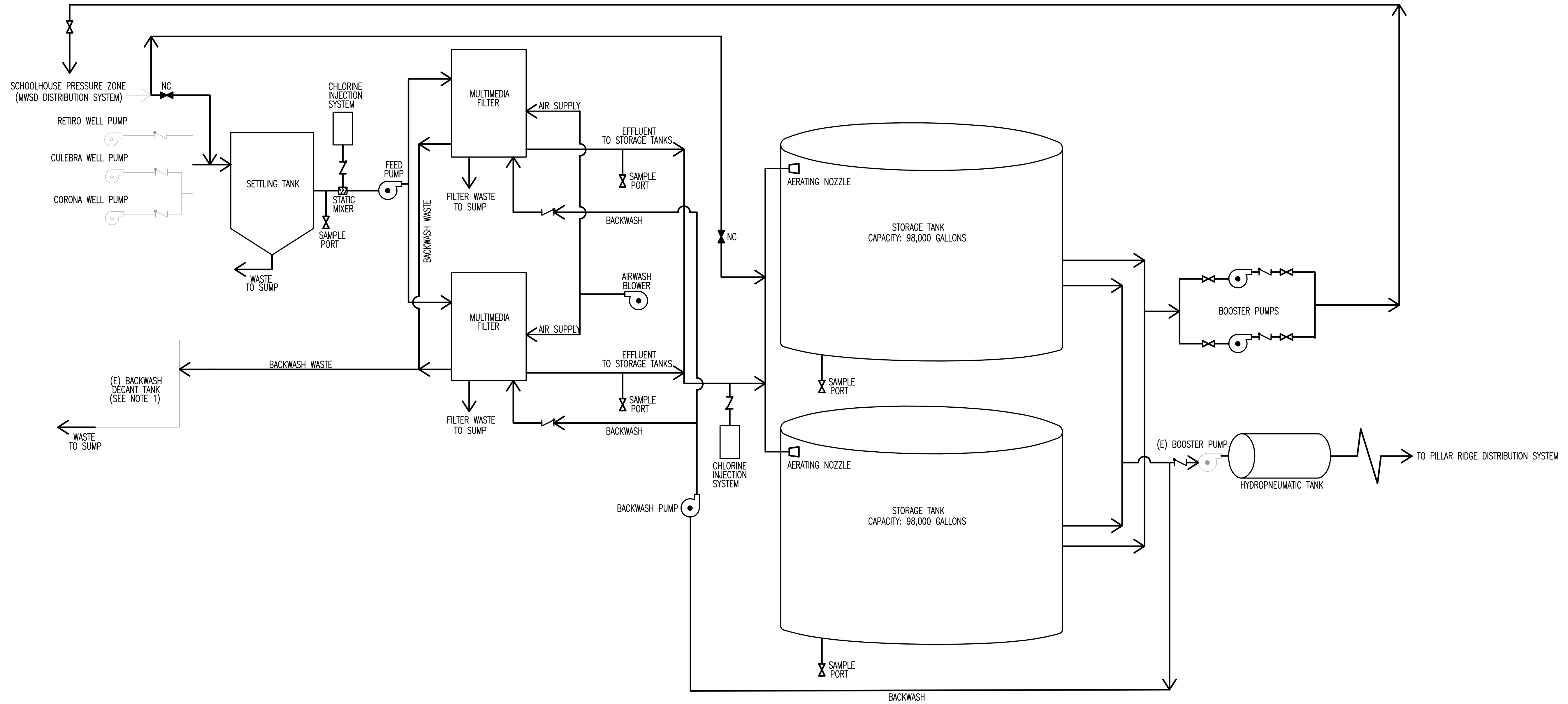

PROCESS FLOW DIAGRAM
 SCALE: NTS

VERIFY SCALE
 0 1"
 BAR IS ONE INCH ON ORIGINAL DRAWING. IF NOT ONE INCH ON THIS SHEET, ADJUST SCALES ACCORDINGLY.

SYMBOL	DESCRIPTION	DATE	APPROVED
-	30% DESIGN	01/2022	---

NOT FOR CONSTRUCTION

SRT CONSULTANTS
 792 Bay Street
 San Francisco, CA 94109
 Ph 415.776.5800
 Fx 415.776.5200

MONTARA WATER AND SANITARY DISTRICT
 8888 CABRILLO HIGHWAY
 MONTARA, CA 94037

PILLAR RIDGE WATER TREATMENT PLANT IMPROVEMENT PROJECT
 PROCESS FLOW DIAGRAM

DATE	JAN 2022
SCALE	AS SHOWN
DESIGN	EGBEOLA-MARTIAL
DRAWN	CHIMELSKI
CHECK	MAO
SHEET	04 of 10

C01

DRAWING NAME: \\newserv\proj\01_PROJECTS\Montara Water and Sanitary District (1000)01_ACTIVE\Pillar Ridge Improvements\02_TAS\CA\Sheets\C01.dwg
 PLOT DATE: Jan 12, 2022 3:52pm
 PLOTTED BY: Laura

DRAWING NAME: \\newserv\proj\PROJECTS\Montara Water and Sanitary District (1000)\01_ACTIVE\Pillar Ridge Improvements\02_TAS\CA\Sheets\C02.dwg
 PLOT DATE: Jan 13, 2022 12:41pm
 PLOTTED BY: Laura

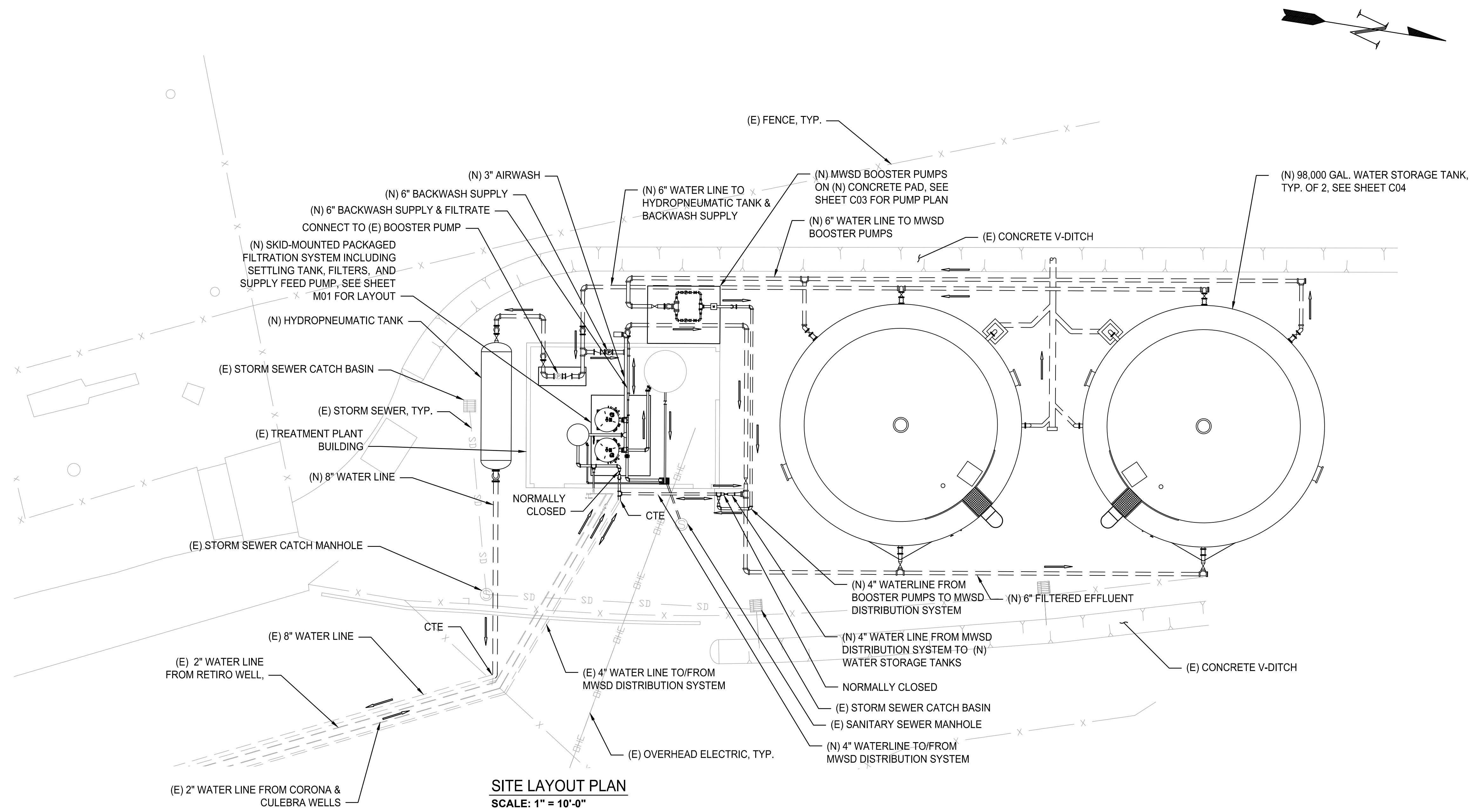

SITE LAYOUT PLAN
 SCALE: 1" = 10'-0"

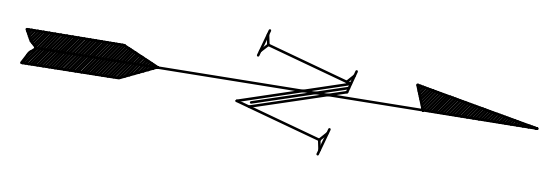

NOT FOR CONSTRUCTION

SRT consultants
 792 Bay Street
 San Francisco, CA 94109
 Ph 415.776.5800
 Fx 415.776.5200

MONTARA WATER AND SANITARY DISTRICT
 8888 CABRILLO HIGHWAY
 MONTARA, CA 94037

PILLAR RIDGE WATER TREATMENT PLANT IMPROVEMENT PROJECT
 SITE LAYOUT

DATE	JAN 2022
SCALE	AS SHOWN
DESIGN	EGBEOLA-MARTIAL
DRAWN	CHIMELSKI
CHECK	MAO
SHEET	05 of 10

VERIFY SCALE
 0 1"
 BAR IS ONE INCH ON ORIGINAL DRAWING. IF NOT ONE INCH ON THIS SHEET, ADJUST SCALES ACCORDINGLY.

C02

SYMBOL	DESCRIPTION	DATE	APPROVED
- 30% DESIGN		01/2022	

REVISIONS

DRAWING NAME: \\newserv\proj\PROJECTS\Montara Water and Sanitary District (1000)01_ACTIVE\Pillar Ridge Improvements\02_TAS\SD\CA\Sheets\003.dwg
 PLOT DATE: Jan 13, 2022 - 12:45pm
 PLOTTED BY: Laura

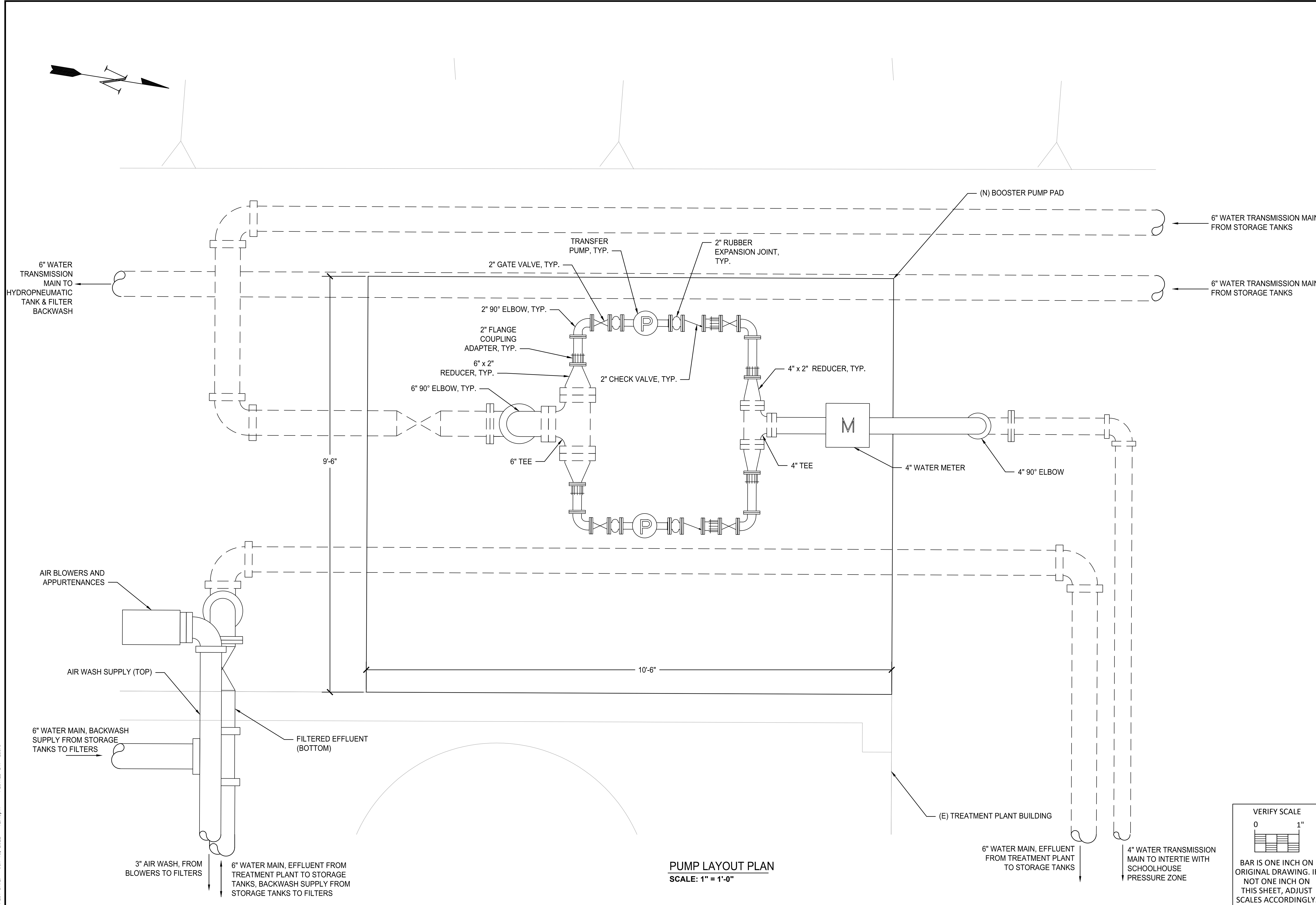

PUMP LAYOUT PLAN
 SCALE: 1" = 1'-0"

VERIFY SCALE

BAR IS ONE INCH ON ORIGINAL DRAWING. IF NOT ONE INCH ON THIS SHEET, ADJUST SCALES ACCORDINGLY.

SYMBOL	DESCRIPTION	DATE	APPROVED
-	30% DESIGN	01/2022	---

NOT FOR CONSTRUCTION

SRT CONSULTANTS
 792 Bay Street
 San Francisco, CA 94109
 Ph 415.776.5800
 Fx 415.776.5200

MONTARA WATER AND SANITARY DISTRICT
 8888 CABRILLO HIGHWAY
 MONTARA, CA 94037

PILLAR RIDGE WATER TREATMENT PLANT IMPROVEMENT PROJECT
PUMP PLAN

DATE	JAN 2022
SCALE	AS SHOWN
DESIGN	EGBEOLA-MARTIAL
DRAWN	CHIMELSKI
CHECK	MAO
SHEET	06 of 10

C03

DRAWING NAME: \\nasnet\proj\01_PROJECTS\Montara Water and Sanitary District (1000)\01_ACTIVE\Pillar Ridge Improvements\02_TANKS\C04_Sheets\C04.dwg
 PLOT DATE: Jun 13, 2022 12:47pm
 PLOTTED BY: Laura

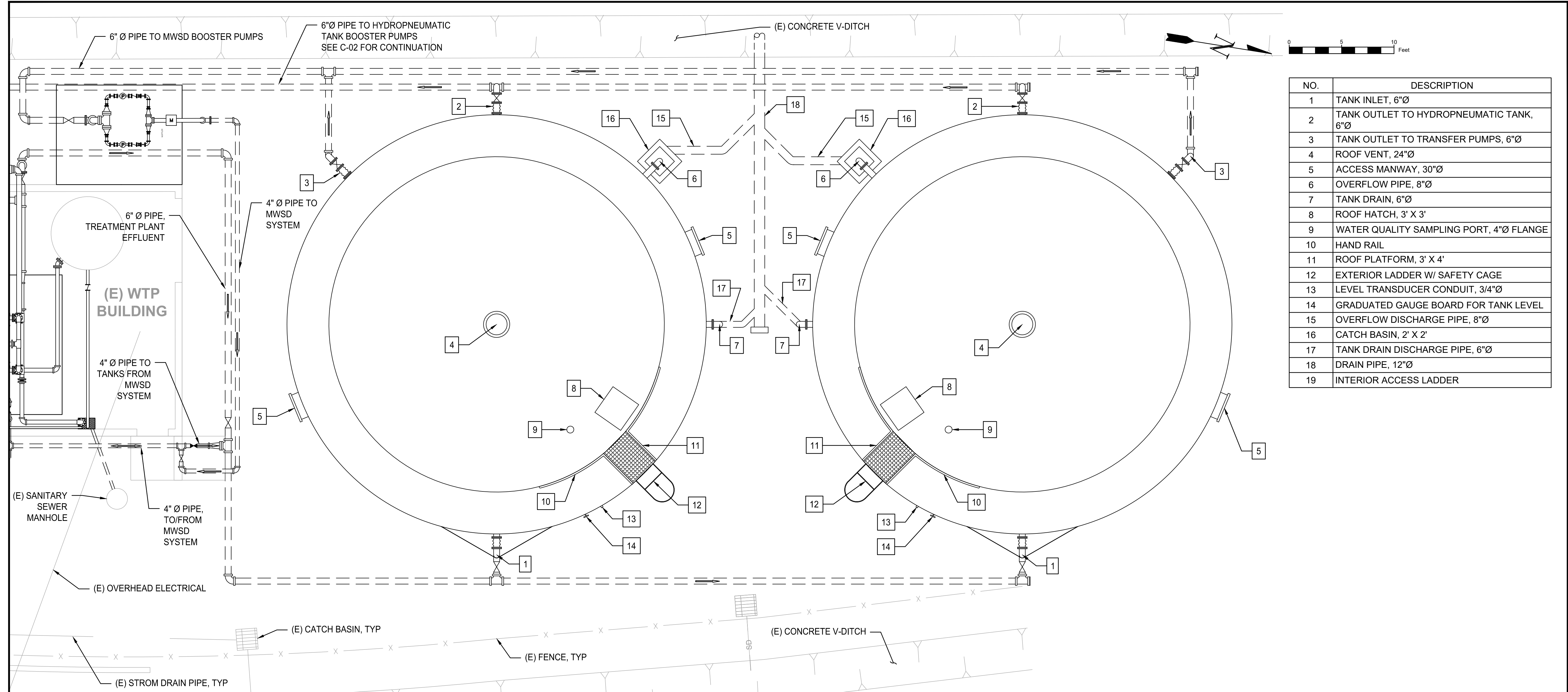

NO.	DESCRIPTION
1	TANK INLET, 6"Ø
2	TANK OUTLET TO HYDROPNEUMATIC TANK, 6"Ø
3	TANK OUTLET TO TRANSFER PUMPS, 6"Ø
4	ROOF VENT, 24"Ø
5	ACCESS MANWAY, 30"Ø
6	OVERFLOW PIPE, 8"Ø
7	TANK DRAIN, 6"Ø
8	ROOF HATCH, 3' X 3'
9	WATER QUALITY SAMPLING PORT, 4"Ø FLANGE
10	HAND RAIL
11	ROOF PLATFORM, 3' X 4'
12	EXTERIOR LADDER W/ SAFETY CAGE
13	LEVEL TRANSDUCER CONDUIT, 3/4"Ø
14	GRADUATED GAUGE BOARD FOR TANK LEVEL
15	OVERFLOW DISCHARGE PIPE, 8"Ø
16	CATCH BASIN, 2' X 2'
17	TANK DRAIN DISCHARGE PIPE, 6"Ø
18	DRAIN PIPE, 12"Ø
19	INTERIOR ACCESS LADDER

PILLAR RIDGE WTP STORAGE TANKS PLANVIEW
SCALE: 1" = 5'

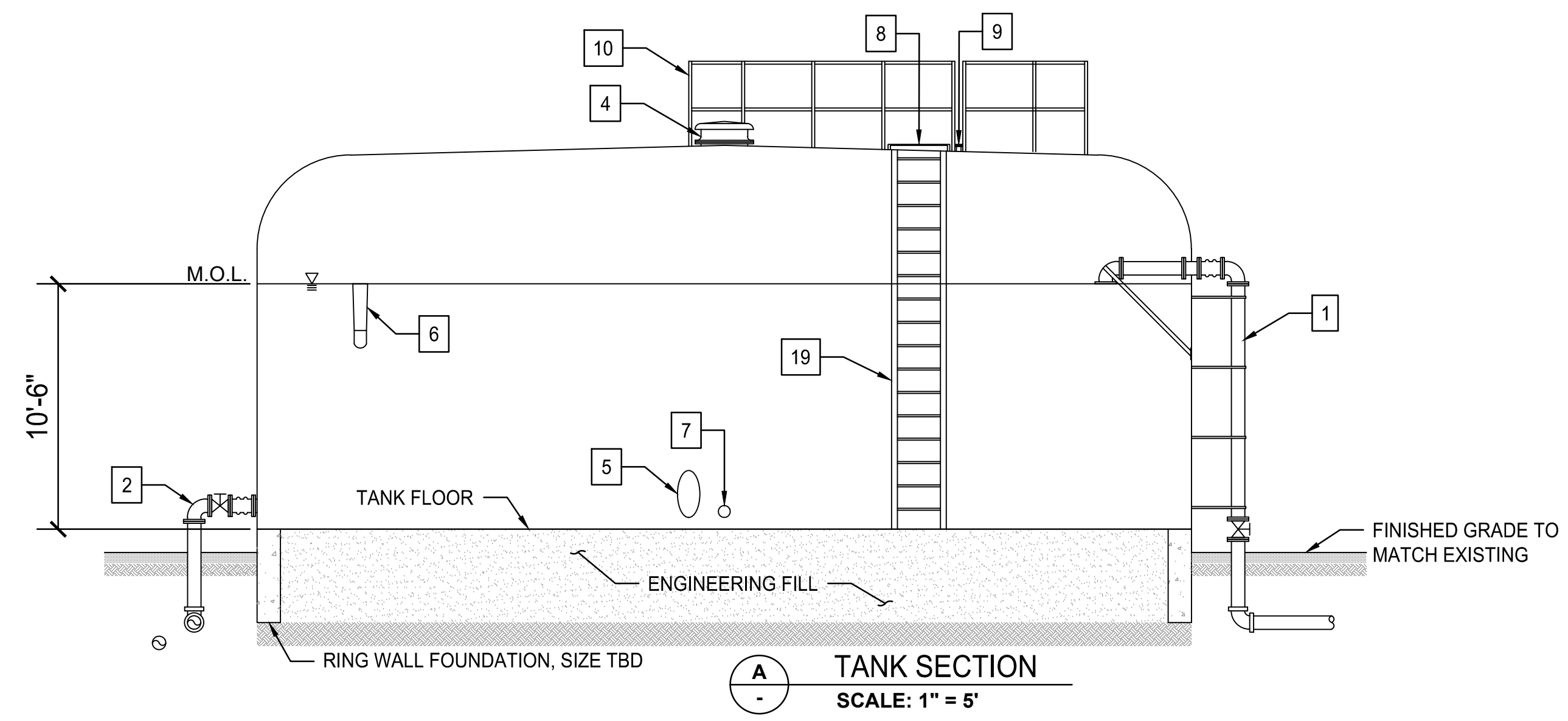

TANK SECTION
SCALE: 1" = 5'

VERIFY SCALE

BAR IS ONE INCH ON ORIGINAL DRAWING. IF NOT ONE INCH ON THIS SHEET, ADJUST SCALES ACCORDINGLY.

NO.	DATE	APPROVED
1	01/2022	

NO.	DESCRIPTION	REVISIONS
1		

SRT consultants
 792 Bay Street
 San Francisco, CA 94109
 Ph 415.776.5800
 Fx 415.776.5200

MONTARA WATER AND SANITARY DISTRICT
 8888 CABRILLO HIGHWAY
 MONTARA CA 94037

PILLAR RIDGE WATER TREATMENT PLANT IMPROVEMENT PROJECT
 STORAGE TANKS PLAN

DATE	JAN 2022
SCALE	AS SHOWN
DESIGN	L.EGBEOLA-MARTIAL
DRAWN	N.MAO
CHECK	
SHEET	07 of 10

C04



MONTARA WATER AND SANITARY DISTRICT AGENDA

For Meeting Of: **January 20, 2022**

TO: BOARD OF DIRECTORS

FROM: Clemens Heldmaier, General Manager

SUBJECT: Review of MWSD's Receipt of Association of California Water Agencies Joint Powers Authority President's Special Recognition Award.

The District received its six Special Recognition Award from ACWA JPIA. On January 1, 2013 the District changed Workers Compensation Insurance Providers to the Association of California Water Agencies Joint Power Insurance Authority (ACWA/JPIA). At the time the District's Workers Comp Rate was due to claims made in prior years. Since then District staff has worked closely with ACWA/JPIA staff to prevent further losses.

At the ACWA Fall Conference the JPIA recognized the District's efforts and presented the District with the "President's Special Recognition Award".

RECOMMENDATION:

This is for Board information only.

Attachments



YOUR BEST PROTECTION

ACWA JPIA

P. O. Box 619082
Roseville, CA 95661-9082

phone
916.786.5742
800.231.5742

www.acwajpia.com

President

E.G. "Jerry" Gladbach

Vice President

Tom Cuquet

Chief Executive Officer

Walter "Andy" Sells

Executive Committee

Fred Bockmiller

Tom Cuquet

David Drake

E.G. "Jerry" Gladbach

Brent Hastey

Melody A. McDonald

Randall Reed

J. Bruce Rupp

Pamela Tobin

Core Values

- People
- Service
- Integrity
- Innovation

November 03, 2021

Montara Water and Sanitary District (M027)
P.O. Box 370131
Montara, CA 94037

General Manager:

Each year at Fall Conference, the JPIA recognizes members that have a Loss Ratio of 20% or less in either of the Liability, Property, or Workers' Compensation programs (loss ratio = total losses / total premiums).

The members with this distinction receive the "**President's Special Recognition Award**" certificate for each Program that they qualify in.

The JPIA is extremely pleased to present Montara Water and Sanitary District (M027) with this special recognition and commends the District on the hard work in reducing claims.

Congratulations to you, your staff, Board, and District. Keep up the good work!

The JPIA wishes you the best in 2022.

Sincerely,

E.G. "Jerry" Gladbach
President

Enclosure: President's Special Recognition Award(s)



President's Special Recognition Award

*The President of the
ACWA JPIA
hereby gives Special Recognition to*

Montara Water and Sanitary District

*for achieving a low ratio of "Paid Claims and Case Reserves" to "Deposit Premiums"
in the Workers' Compensation Program for the period 07/01/2017 - 06/30/2020
announced at the Board of Directors' Meeting in Pasadena.*

E. G. "Jerry" Gladbach

E. G. "Jerry" Gladbach, President



December 15, 2021